

SITE PLAN & LOCATION PLAN OF PROPOSED (G+3) FOUR STOREIED RESIDENTIAL FLAT BUILDING OF R.S. DAG NO-546, L.R. DAG NO.-1288, L.R. KH. NO.-5231 & 5252, MOUZA- UTTAR BAKSARA, J.L. NO.-07, P.S.- SANTRAGACHH(NEW), UNDER H.M.C WARD NO-45, BOROUGH-VII, HOLDING NO-158/A, LALIT MOHAN CHATTERJEE SARANI, DIST.-HOWRAH.

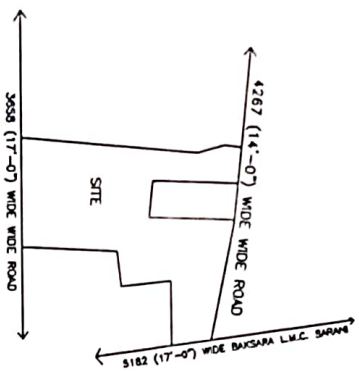
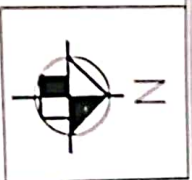

KEY PLAN

SCALE - 1:10000

POINT A =	22°34'48.4"N, 88°17'24.3"E
POINT B =	22°34'47.9"N, 88°17'23.7"E
POINT C =	22°34'46.9"N, 88°17'23.1"E
POINT D =	22°34'47.4"N, 88°17'23.9"E
POINT E =	22°34'48.3"N, 88°17'24.2"E
POINT F =	22°34'47.8"N, 88°17'24.9"E
POINT G =	22°34'48.2"N, 88°17'25.0"E
POINT H =	22°34'47.8"N, 88°17'24.3"E
POINT I =	22°34'47.4"N, 88°17'24.5"E
POINT J =	22°34'47.2"N, 88°17'23.3"E
POINT K =	22°34'46.8"N, 88°17'23.4"E
POINT L =	22°34'47.0"N, 88°17'23.3"E

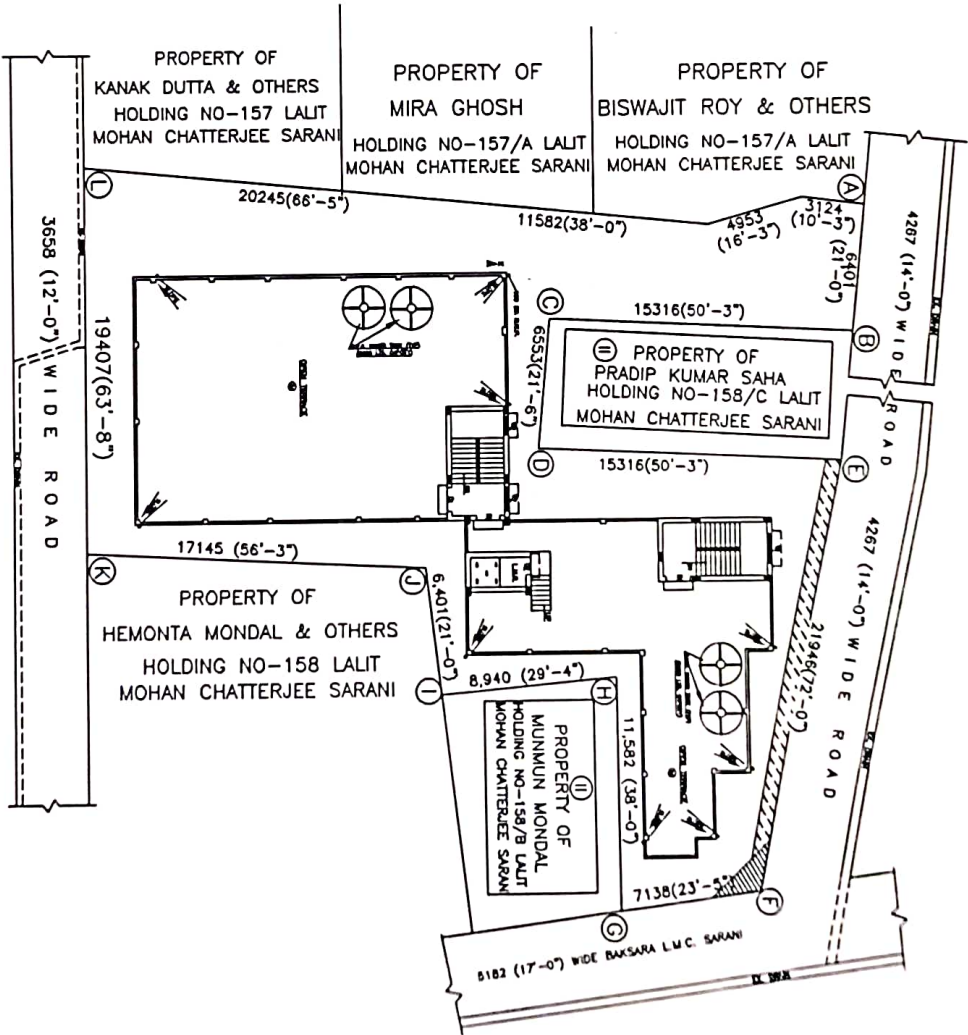

MAA BHABATARINI REALTOR PVT. LTD.

Maa Bhabatarini

Director.

SITE PLAN.

SCALE = 1:600